

STEP 1

Close the umbrella

STEP 2

Remove the screw on the cover end

STEP 3

Disassemble the knob on umbrella pole, and remove the cover and solar component

STEP 4

Remove the screws on base and separate the tube from the cross base

A	Parasol		1PC
B	Cross Base 1		1PC
C	Cross Base 2		1PC
D	Base tube		1PC
E	Bolt	M8*20MM	4PC
F	Washer		4PC
G	6# Wrench		1PC
H	Crank Handle		1PC

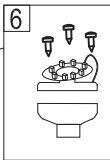
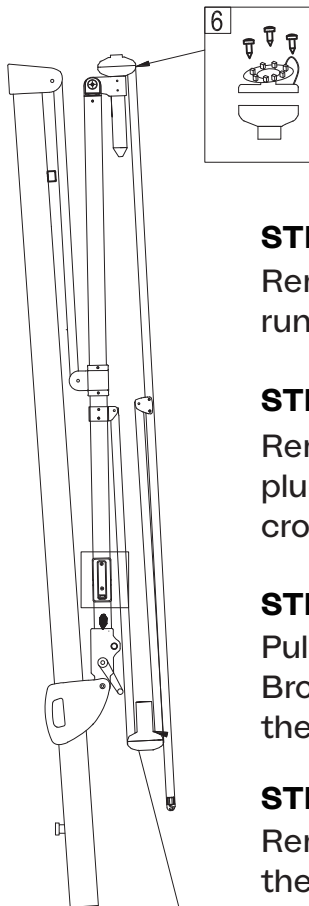

STEP 5

Remove the screws in runner and separate runner and rib

STEP 6

Remove the screws in crown and pull out the plugs on the annular plate, then separate the crown and ribs.

STEP 7

Pull out the plugs and light strips in long ribs. Broken the screws on the hinges and separate the long and short ribs.

STEP 8

Remove the screws on the battery base on the cantilever, and pull out the wire and plug.

